



PRODUCT OVERVIEW

ETI's full cutoff design maximizes light distribution and application spacing while **eliminating uplight**. It features three selectable CCTs and three selectable wattages—offering flexibility and efficiency.

Equipped with 0-10V dimming, universal 120-277 voltage, and Dusk-to-Dawn Photocell with enable/disable capability, this wall pack is ideal for security lighting around building perimeters and other applications where minimized light pollution is desired.



INNOVATE. ILLUMINATE. INSPIRE.

FULL CUTOFF LED WALL PACK | 3 LUMEN BOOST® | 3 CCT COLOR PREFERENCE®

PERFORMANCE SUMMARY				
Lumen Packages	Lumen Pkg. Range (LB3)	Selectable Watt. Levels	CCT (CP3)	Distribution
Lumen Pkg 1	4000 – 8000	20 40 60	3000K 4000K 5000K	 TYPE IV
Lumen Pkg 2	9000 – 14000	60 80 100	3000K 4000K 5000K	

Dusk to Dawn Photocell w/ enable/disable capability

Hinged Access for wiring, Wattage & CCT select access



ELECTRICAL DATA
Operation: 120-277V, 50/60Hz
Low Temp Start / Max Temp: -40° C (-40 F) / 50° C (122° F)
Controls: 0-10V, Photocell Dusk-to-Dawn
CERTIFICATIONS & OTHER INFO
Warranty: 5 year
UL/cUL Listed: Wet location, IP65 Rated

Removable heatsink allows for easier mount and install.

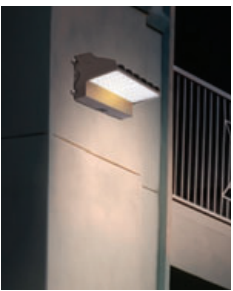
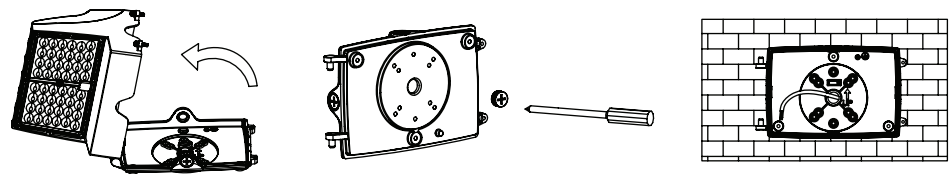

Dark Sky Compatible*
Full Cutoff Wall Pack can be utilized in dark sky compliant plans when set to 3000K.

MTO OPTIONS

Full Cutoff Wall Packs are also available with installed 8W Battery Backup.