



## PRODUCT OVERVIEW

With an art deco flare and modern-retro feel, ETI's Estelle Series adds that special touch to modern, eclectic and other styles. These integrated LED lights have **3 Color Preference®** field-selectable CCT options and a soft, comfortable light quality. Available in White or Black Finish with Gold Trim.

Integrated LED with diffused lens

Long Life: > 50,000 hours (L70)

3 CCT: 3000K, 4000K, 5000K | CRI: 80+

-4°F to 104°F (-20°C to 40°C)

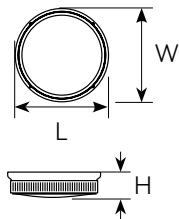

Model #	Description	Energy/Performance		Dimensions/Weights			
		Watts	Lumens	L	W	H	weight (lbs)
C01184401A	Black Finish	30	1600	15.0"	15.0"	4.2"	2.5
C01184402A	White Finish	30	1800	15.0"	15.0"	4.2"	2.5



Easy access to color temperature select switch underneath twist-off lens

Series	Size (Dia.)	CRI	CCT	Voltage	Dim.	Finish	Finish
ESFM Estelle Flush Mount	15 (15")	8 80+ CRI	CP3 <sup>2</sup> 3 CCT	SV 120V	TD TRIAC Dimming	WH White Finish BL Black Finish	GT Gold Trim



Mounting screws and wire connectors included.

