

## RTLFM | RUTLAND LINEAR FLUSH MOUNT 3 CCT COLOR PREFERENCE®

### KEY FEATURES

- Luminaire uses ETI's patented Color Preference® with 3 Selectable CCTs Standard (3000K, 4000K, 5000K), plus NightLightR™, 2000K nightlight feature
- 80+ CRI
- TRIAC Dimming Down to 10% (120V)

### SPECIFICATIONS

#### Construction

- Cold Rolled Steel Back Plate
- White Finish

#### Optics

- Polymer diffuser lens for zero pixelation and overall visual comfort
- Uniform, even light distribution
- Backlit technology

#### Installation

- Field select CCT using integral switch located on fixture back prior to installation. Ships at 3000K
- Includes Quick Fit Installation Kit. Simply mount the bracket to the ceiling and slide the fixture into place.

#### Electrical

- > 50,000 hour LEDs at L70 for reduced maintenance
- Operates at 120V, 60Hz
- TRIAC dimming, down to 10%\* (120V)
- Operating Temperature: -4°F to 104°F (-20°C to 40°C)
- ETI's patented selectable CCT COLOR PREFERENCE® allows for easy field-adjustable color temperature selection with switch located on fixture back.

\* Always consult dimmer manufacturer for proper use, installation and compatibility (some dimmers may require a neutral in the wall box).

#### Warranty

5-Year Standard Warranty. See terms at: [ETISSL.com/warranty/](https://www.etissl.com/warranty/)

KEY DATA	
LUMEN RANGE	4322 – 4890
WATTAGE RANGE	53.6 – 57.4
EFFICACY RANGE (LPW)	81 – 85
REPORTED LIFE (HOURS)	L70 / > 50,000

DATE:	PROJECT:
TYPE:	NOTES:
CATALOG #:	

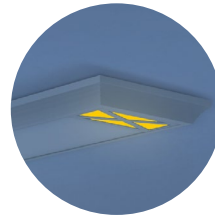

NightLightR™

Color Preference®



#### Certifications & Test Data

- All luminaires are ETL Listed (US, C) for Damp Location
- Adheres to LM63, LM79, LM80 and TM21 industry standards for photometric, lumen maintenance and lifetime calculations
- Suitable for use in closets when installed in accordance to NEC Section 410.16 (A)(1) and 410.16 (C)(1)



CATALOG LOGIC

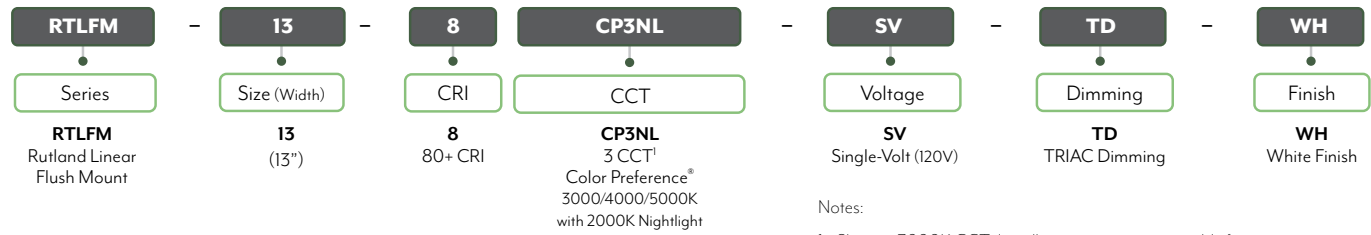

Notes:  
 1. Ships at 3000K CCT. Installing contractor responsible for ensuring desired CCT selected during installation.

STOCK ORDERING INFORMATION

CATALOG PART NUMBER	ORDER NUMBER	DESCRIPTION	CASE QTY	CRI	CCT	WATTS (NOM.)	LUMEN PKG. <sup>1</sup>	DELIVERED LUMENS	LPW	VOLTAGE	DIM
RTLFM-13-8CP3NL-SV-TD-WH	C05008402A	Rutland Linear Flush Mount with Nightlight, 4' x 13"	2	80+	Nightlight	20	250	265	19	120V	TRIAC
					3000K	55	4500	4137	75		
					4000K	55	4500	4631	79		
					5000K	55	4500	4185	75		

Notes: 1. For more delivered lumens and test data see pages 3, or visit ETISSL.com

DIMENSIONS / DETAILS

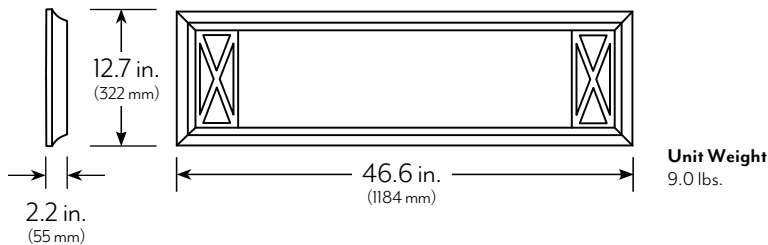

Easy access to color temperature on back

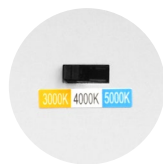

Ships at 3000K

NightLightR®

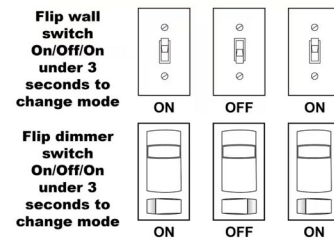
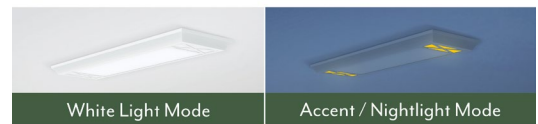

MOUNTING

Includes Quick Fit Installation Kit:  
 Simply mount the bracket to the ceiling and slide the fixture into place.

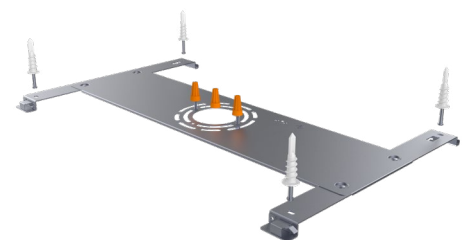

**PERFORMANCE / Data**

**Lumen Maintenance**

Ambient Temp.	TM-21 Lumen Maintenance (54,000 hours)
25° C (77° F)	89%
Ambient Temp.	TM-21 Theoretical L70 (hours)
25° C (77° F)	> 50,000

**Load Information**

<b>Power Factor</b>	> 0.90
<b>THD</b>	< 20%
<b>Frequency</b>	60 Hz
<b>Low Temp Start / Max Temp</b>	-4°F to 104°F (-20°C to 40°C)

**DIMMER COMPATIBILITY LIST**

DIMMER BRAND	DIMMER MODEL
<b>TRIAC DIMMERS</b>	
LUTRON	MACL-I53MLH-WH
LUTRON	STCL-I53PH-WH
LEVITON	R11-DSL06-1TW
LEVITON	R00-RNL06-0TW
LEVITON	R02-DW6HD-2RW
TP-LINK	HS220
COMMERCIAL ELECTRIC	HPDA311CWB
LUTRON	LECL-I53
LUTRON	SCL-I53P
LUTRON	NTCL-250
LUTRON	GT-I50
LEVITON	DSL06-ILZ
LEVITON	TSL06
LEVITON	RDL06
COOPER	9540
COOPER	9573
COOPER	DLC03P
COOPER	SUT7
COOPER	TAL06P2

**PHOTOMETRIC SAMPLES**



**Luminaire Data:**

CCT & CRI	<b>4000K, 80+ CRI</b>
DELIVERED LUMENS	<b>4631</b>
WATTAGE	<b>58.4W</b>
EFFICACY	<b>79</b>
SPACING	<b>0° = 1.34 90° = 1.25</b>

Photometric values based on tests performed in compliance with LM-63 & LM-79

**Candela Plot**

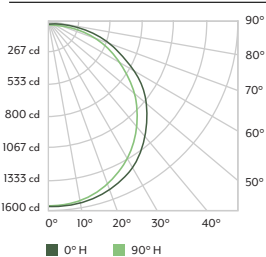

\* Always consult dimmer manufacturer for proper use, installation and compatibility (some dimmers may require a neutral in the wall box).